

100
0 10
Millimetres

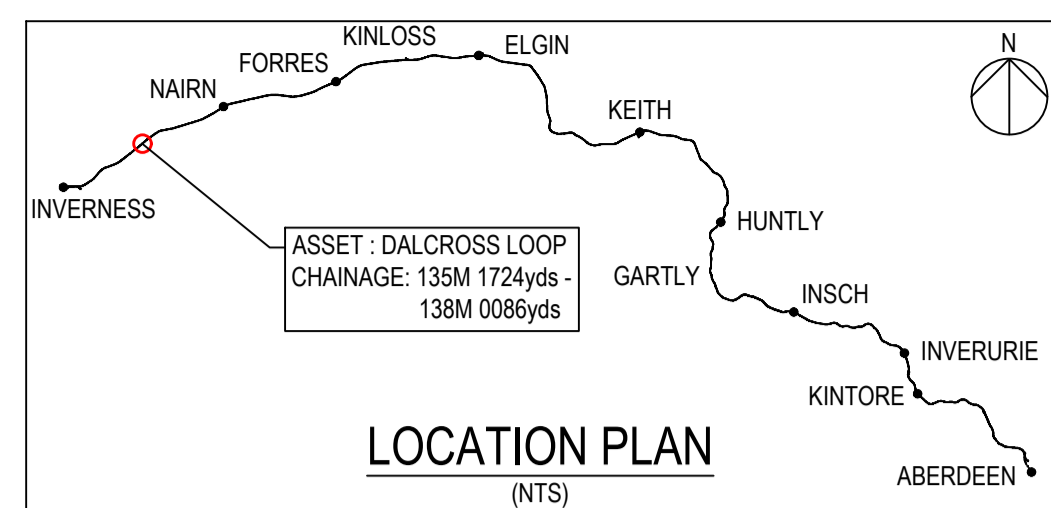
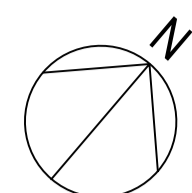

- GENERAL NOTES
1. THIS DRAWING IS TO BE READ IN CONJUNCTION WITH ALL OTHER RELEVANT DOCUMENTATION.
 2. DO NOT SCALE FROM THIS DRAWING. USE ONLY PRINTED DIMENSIONS.
 3. ALL DIMENSIONS IN MILLIMETRES. ALL CHANGES, LEVELS AND COORDINATES ARE IN METRES UNLESS DEFINED OTHERWISE.
 4. THIS DRAWING IS TO BE READ IN CONJUNCTION WITH THE PROJECT HEALTH & SAFETY FILE FOR ANY IDENTIFIED POTENTIAL RISKS.
 5. THIS DRAWING IS TO BE READ IN CONJUNCTION WITH:
 - 150005-BNU-DRG-EMF-001021.

KEY:

- BOUNDARY OF DEVELOPMENT
- NETWORK RAIL BOUNDARY
- PROPOSED WORKS
- OS MAPPING

NOT FOR CONSTRUCTION

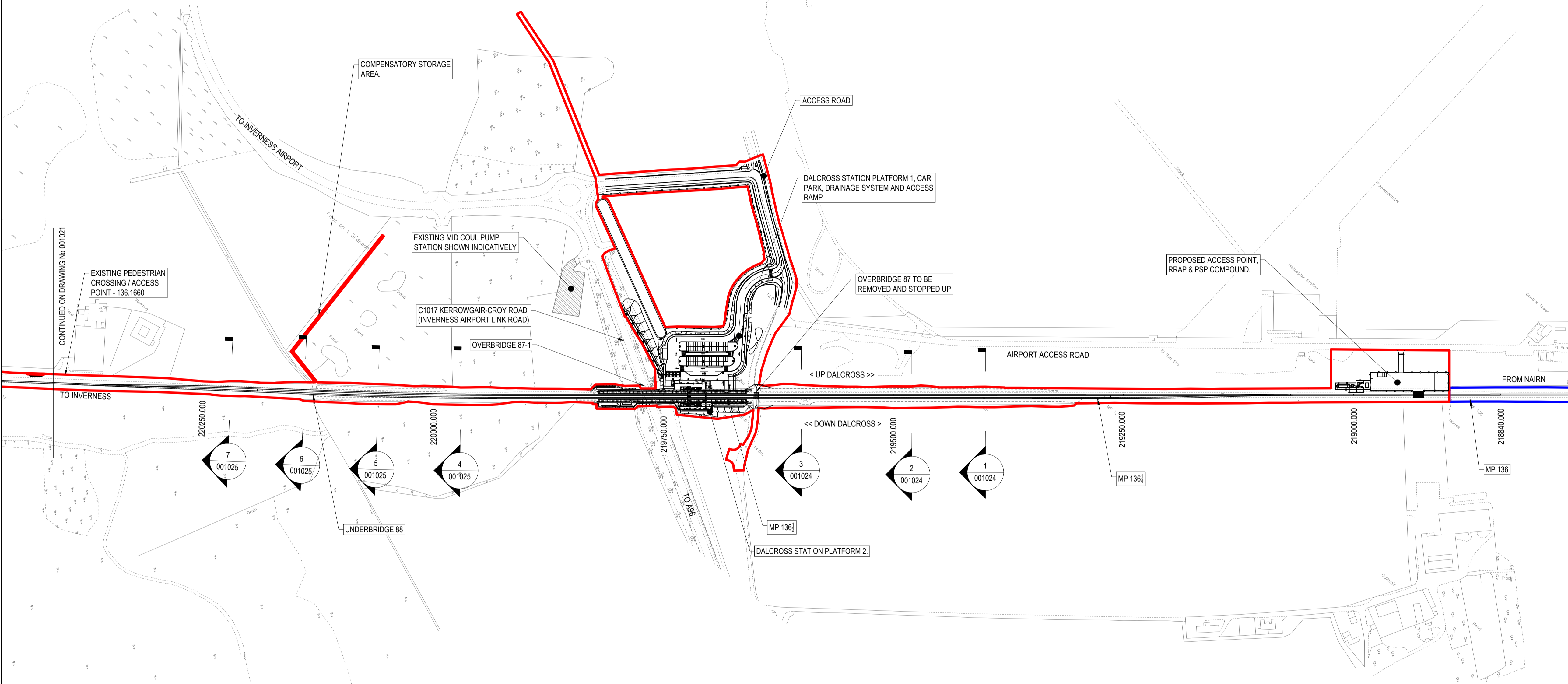

Rev	Date	Issue History	Drawn	Chkd	Appd
P02	16.10.20	ISSUED FOR INFORMATION	MM	GM	NM
P01	29.07.20	ISSUED FOR INFORMATION	MM	NM	NM

Description of Change

FOR INFORMATION

AECOM
Citypoint 2
25 Tynndrum Street
Glasgow, G4 0JY
Tel: +44 (0)141 202 0500

NetworkRail **bam**

Project Title
**HIGHLANDS ENHANCEMENTS PROGRAMME
ABERDEEN TO INVERNESS**

Drawing Title
**DALCROSS LOOP
LOCATION PLAN
SHEET 1 OF 2**

Drawn	Date	Designed	Date
MM	29.07.20	GM	29.07.20
Checked	Date	Approved	Date
NM	29.07.20	NM	29.07.20

Scale	Location
A1	DALCROSS

Drawing Number: 150005-BNU-DRG-EMF-001020
Revision: P 02

Userame: greg.mitchell Date: 16/10/20 16:20:09 Filename: C:\users\greg.mitchell\documents\dms08491150005-BNU-DRG-EMF-001020.dwg

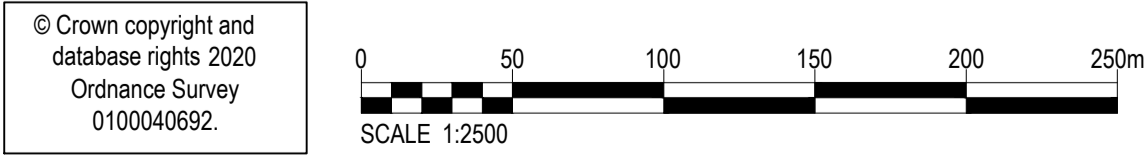

THIS DOCUMENT HAS BEEN PREPARED PURSUANT TO AND SUBJECT TO THE TERMS OF AECOM'S APPOINTMENT BY ITS CLIENT. AECOM ACCEPTS NO LIABILITY FOR ANY USE OF THIS DOCUMENT OTHER THAN BY ITS ORIGINAL CLIENT OR FOLLOWING AECOM'S EXPRESS AGREEMENT TO SUCH USE, AND ONLY FOR THE PURPOSES FOR WHICH IT WAS PREPARED AND PROVIDED.

SAFETY, HEALTH AND ENVIRONMENTAL INFORMATION BOX

IT IS ASSUMED THAT ALL WORKS ON THIS DRAWING WILL BE CARRIED OUT BY A COMPETENT CONTRACTOR WORKING WHERE APPROPRIATE TO AN APPROVED SAFE METHOD OF WORKING

THIS DRAWING IS TO BE USED ONLY FOR THE PURPOSE OF ISSUE THAT IT WAS ISSUED FOR AND IS SUBJECT TO AMENDMENT.